

61920

Dimensions

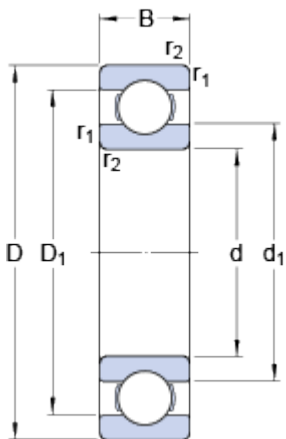

d	100	mm
D	140	mm
B	20	mm
d_1	≈ 112.9	mm
D_1	≈ 127.1	mm
$r_{1,2}$	min. 1.1	mm

Abutment dimensions

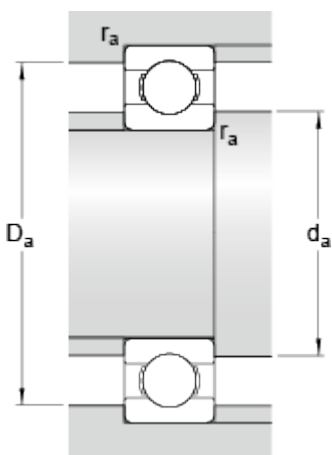

d_a	min. 106	mm
D_a	max. 134	mm
r_a	max. 1	mm

Calculation data

Basic dynamic load rating	C	42.3	kN
Basic static load rating	C_0	41.5	kN
Fatigue load limit	P_u	1.63	kN
Reference speed		9500	r/min
Limiting speed		6000	r/min
Calculation factor	k_r	0.02	
Calculation factor	f_0	16.4	

Mass

Mass bearing	0.83	kg
--------------	------	----